



McVeigh Parker

GRIPPLE TORQ TOOL

SPECIFICATION SHEET

A1510

The Gripple Torq Tensioning Tool not only tensions wire but regulates the load applied too, delivering consistent results and maximising the life of your wire.

Features/ Benefits

- Lightweight and compact
- Designed with an in-built gauge, controls the tension applied to the wire
- One tool works on all Gripple tensioners on up to 6mm diameter wire
- Ensures consistent tension every time, optimising the life of wires
- Gear driven handles provide 6:1 mechanical advantage, allows tensioning with minimal effort



Wire Range (mm)	Gauge Range (kg)	Max Working Load (kg)
Up to 6.00mm	100kg - 300kg	300kg

Installation

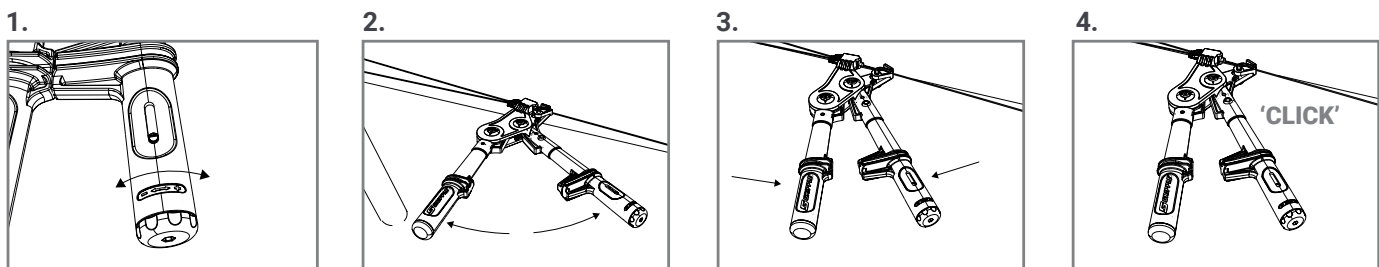

Tips

- If installing on a post which is 'open-side-out', there is a handy adaptor that can be fitted on the tool to make tensioning easier
- Regularly lubricate the cam area for smooth operation
- Replacement cam sets are available should the teeth wear

